

GRAND AVENUE ADDITION

NW 1/4 SEC. 6, T. 1 N., R. 3 E.

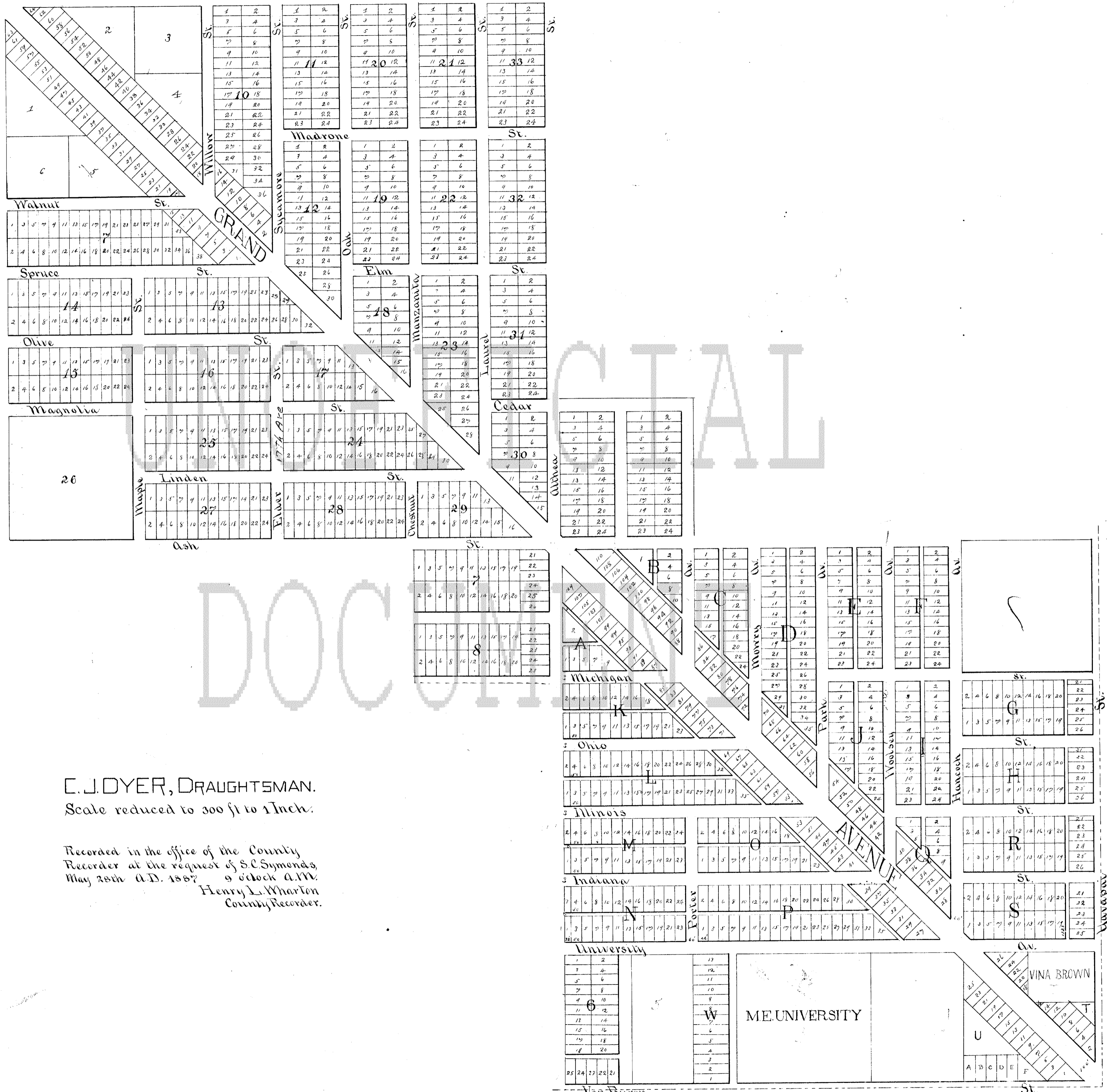

C. J. DYER, DRAUGHTSMAN.
Scale reduced to 300 ft to 1 Inch.

Recorded in the office of the County Recorder at the request of S. C. Symonds, May 25th A.D. 1887, 9 o'clock A.M.
Henry L. Wharton
County Recorder.

UNIVERSITY ADDITION

SE 1/4 SEC. 6, T. 1 N., R. 3 E.

Book 1 - Page 7

1
7