

WOOLF TRACT

Subdivision of the N. 1/2 S.W. 1/4 Sec. 20. T. 2 N. R. 3 E.

SURVEYED BY H.R. PATRICK

Scale 125 ft. to 1 inch

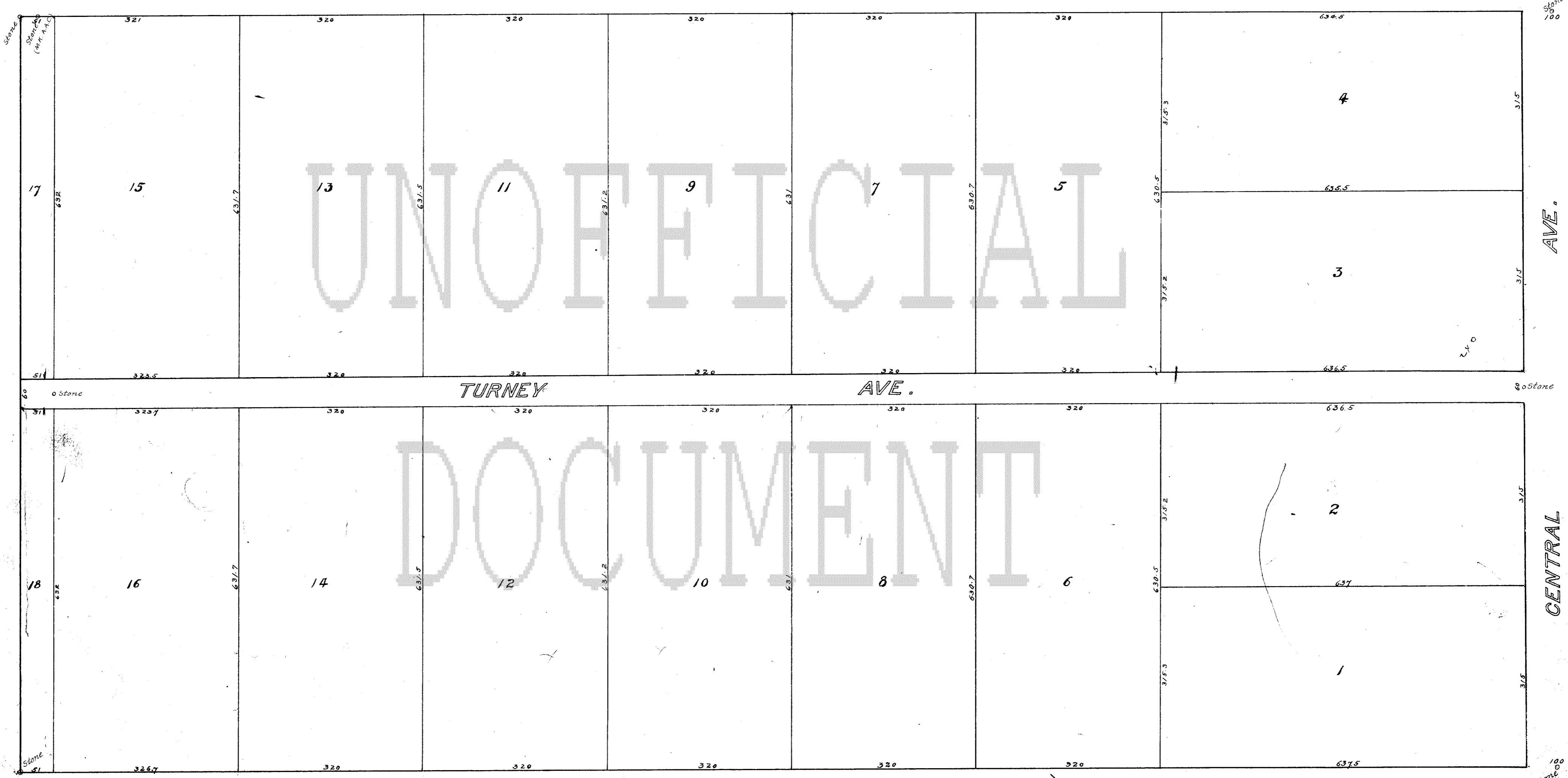

Book 2
Page 32

This plat of lots:-
 Is hereby published as the complete plan and survey thereof, and the tract upon the recording thereof in the County Recorder's office of the County of Maricopa, Territory of Arizona, is dedicated to the public for their use forever. The premises hereby subdivided consists of the North half (1/2) of the South-west quarter (1/4) of Section number Twenty (20), Township number Two (2) North of Range number three (3) East, Gila and Salt River Base and Meridian, County of Maricopa, Territory of Arizona. Witness my hand this seventh day of November, 1893

R. H. Woolf

Recorder's Office, Phoenix, Maricopa Co., A.T.
 Filed and recorded at request of J. W. Evans, Nov. 7th, 1893, at 2:30 P.M.
 Book 2 of Maps. Page
 New Osborn, County Recorder.
 By Mrs. C. Thomas, Deputy.

Territory of Arizona, }
 County of Maricopa }
 Before me, O. A. Turney, a Notary Public in and for said county of Maricopa, on this day personally appeared R. H. Woolf known to me to be the person whose name is subscribed to the foregoing instrument and acknowledged to me that he executed the same for the purpose and consideration therein expressed.



Given under my hand and seal of office this 7th day of November, 1893

O. A. Turney
 Notary Public.

4017